

SECTION 5

REPLACEMENT PARTS

Replacement parts are keyed in Figures 5-1 through 5-4. Order replacement parts by part number and part name as shown on the illustrations. **DO NOT** order by part number alone. Parts may be ordered from your ESAB Welding & Cutting Products distributor or from ESAB Customer Service Department, Florence, SC 29501.

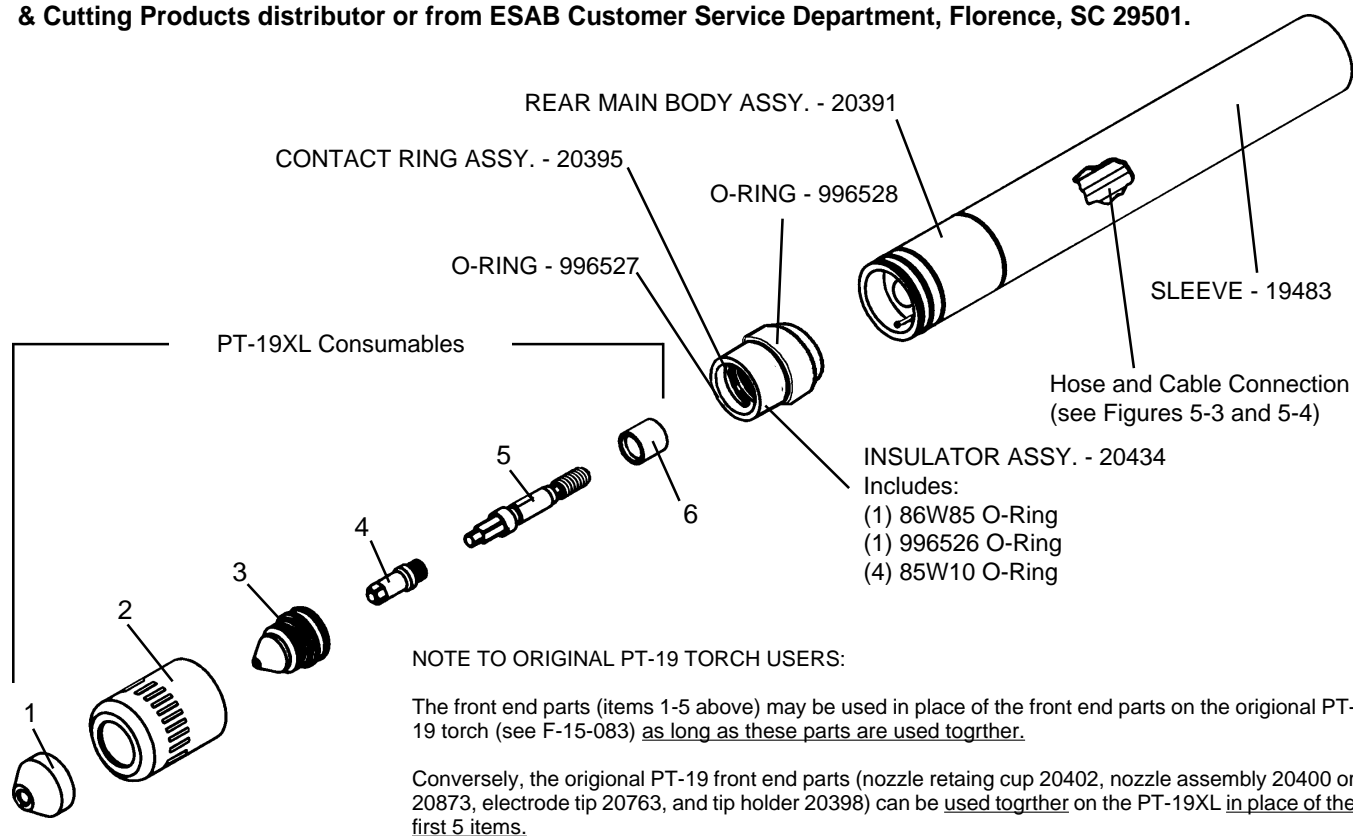

Application		Recommended Replacement Parts					
Current & Gas	Thickness & Material	1 Heat Shield	2 Nozzle Retaining Cup	3 Nozzle	4 Electrode	5 Electrode Holder	6 Gas Baffle
50 to 65A Air & N ₂	1/16 to 1/4" CS, SS, AL	50A 34885	34085	50A 34730	Hafnium 34086	Long 34084	4 Hole Std. 948142 4 Hole Rev. 948143
150A Air & N ₂ O ₂	1/4 to 1" CS,SS,AL 1/4 to 3/4" CS	Std. 948186 H.D. 19506	34085	150A 21821	Hafnium 34086	Long 34084	4 Hole Std. 948142 4 Hole Rev. 948143
250A Air, O ₂ , N ₂	1/2 to 2" CS,SS,AL	Std. 948186 H.D. 19506	34085	250A 21822	Hafnium 34086	Long 34084	8 Hole Std. 2075586 8 Hole Rev. 20918
250A H-35	1/2 to 2" SS,AL	Std. 948186 H.D. 19506	34085	250A 21822	Tungsten 34557	Long 34084	4 Hole Std. 948142 4 Hole Rev. 948143
150A H-35	1/2 to 1" SS,AL	Std. 948186 H.D. 19506	34085	150A 21821	Tungsten 34557	Long 34084	4 Hole Std. 948142 4 Hole Rev. 948143

Figure 5-1. PT-19XL Plasmarc Cutting Torch

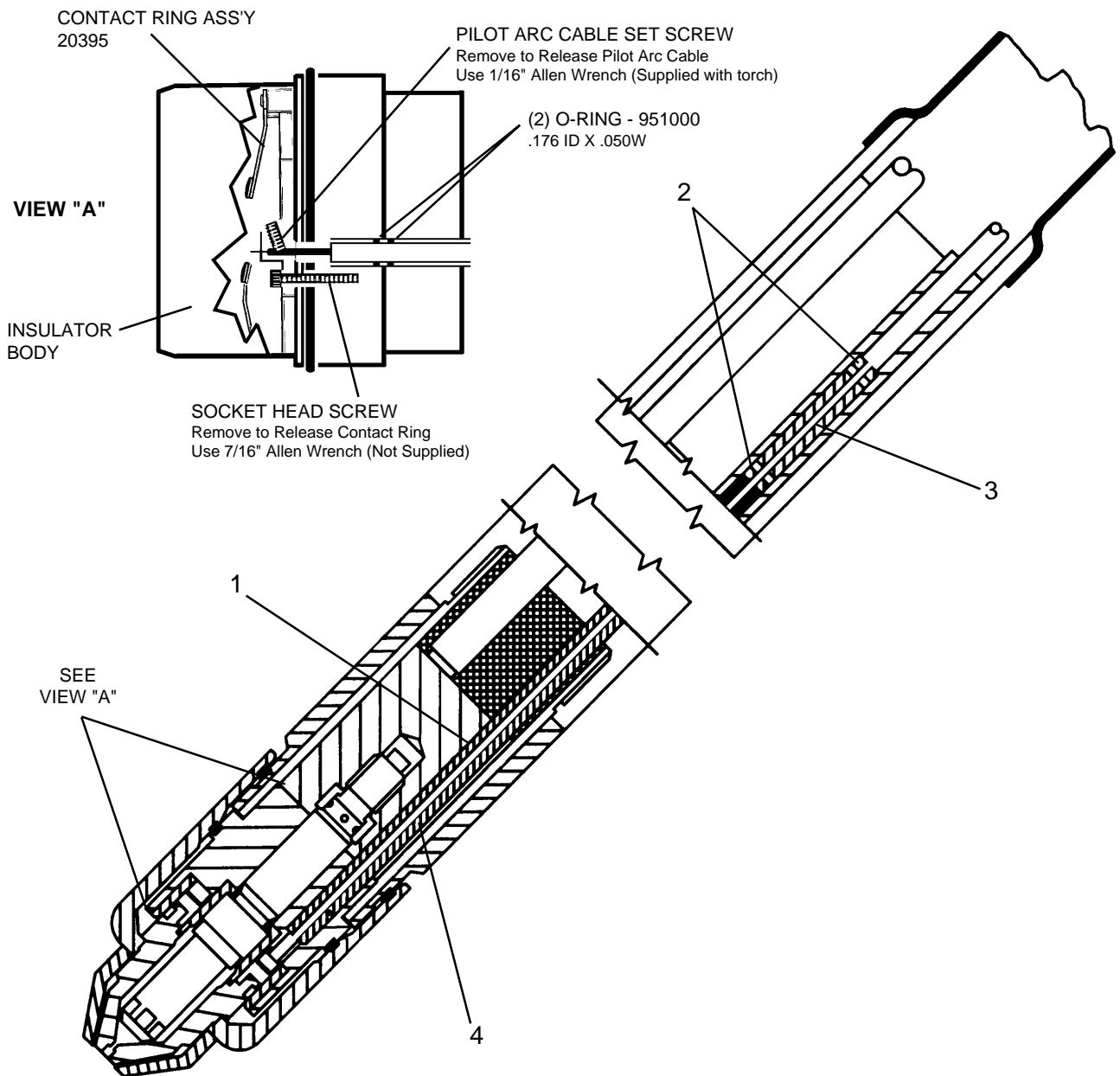

Figure 5-2. Pilot Arc Cable Assembly

Item No.	Qty. Req.	Part No.	Description
1	1	20403	P.A. BUS INSULATOR
2	4	61330980	SCREW, #6-32 X 1/8
3	1	20408	CONNECTOR, HI-FREQ.
4	2	951000	O-RING