

Data sheet for stepper motor 6A

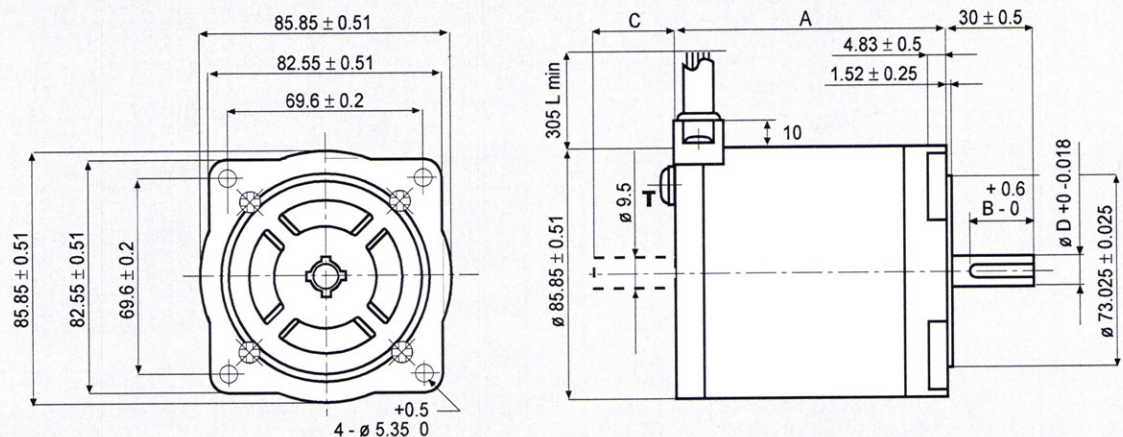

WIRES ARE HOUSED IN A VINYL
TUBE.
T IS THE EARTH TERMINAL

MODEL	A	B	C	D
62	22			9.525

CHARACTERISTICS

MODEL		
BASIC STEP ANGLE		$1.8^{\circ} \pm 0.09^{\circ}$
BIPOLAR CURRENT	(Amp)	6
RESISTANCE	(Ohm)	0.3
INDUCTANCE	(mH)	1.65
BIPOLAR HOLDING TORQUE	(Ncm)	300
ROTOR INERTIA	(Kg $m^2 \times 10^{-7}$)	1450
THEORETICAL ACCELERATION	(rad x sec. $^{-2}$)	20600
BACK E.M.F.	(V/Krpm)	50
MASS	(Kg)	1.5
PROTECTION DEGREE		IP43
LEADS CODE		V

Codes between brackets refer to double shaft model.

