

2 Phase Tin-Can type Stepper Motors (PF/PFC series)

PF/PFC series tin-can motors range in diameter from 25mm to 55mm and are permanent magnet type stepper motors with superior cost and performance. The PF/PFC series motors are ideal for mass production applications. Available in three step angles (3.75° , 7.5° and 15°), a choice of windings and magnet materials (Ferrite Anisotropic, Ferrite Isotropic and Neodymium), the PF/PFC series offers the design engineer the ultimate in flexibility to match the applications requirements with the most cost effective motors. A variety of optional flanges, shafts and gear heads are available to meet the requirements of most applications. Also, upon request, accessories such as ball bearings, pinion gears, pulleys, or connectors can be added to the motor providing a complete assembly. Applications for PF/PFC series include medical equipment, printers, fax machines, copiers, analysis machines and industrial equipment.

Parameters	Unit	PF55-48			
Drive mode		Unipolar		Bipolar	
Excitation Mode		Full-step (2-2 ex)			
Step Angle	°	7.5			
Step Angle Tolerance	%	± 5			
Steps per Revolution		48			
Voltage	V	12	5	12	5
Winding Resistance	Ω/Ø	36	5	40	6.75
Winding Inductance	mH/Ø	43	5.9	84	12
Holding Torque	mN•m	120	120	150	150
Rotor Inertia	kg•m²	40.0 x10 ⁻⁷			
Starting Pulse Rate, Max	pps	300			
Slewing Pulse Rate, Max	pps	310			
Ambient Temp. Range, Operating	°C	-10 ~ + 50			
Temperature rise	K	55			
Mass	g	300			

Note: Above data is based on Rated Voltage Drive. The magnet type is Anisotropic.

Outline Dimension Drawing

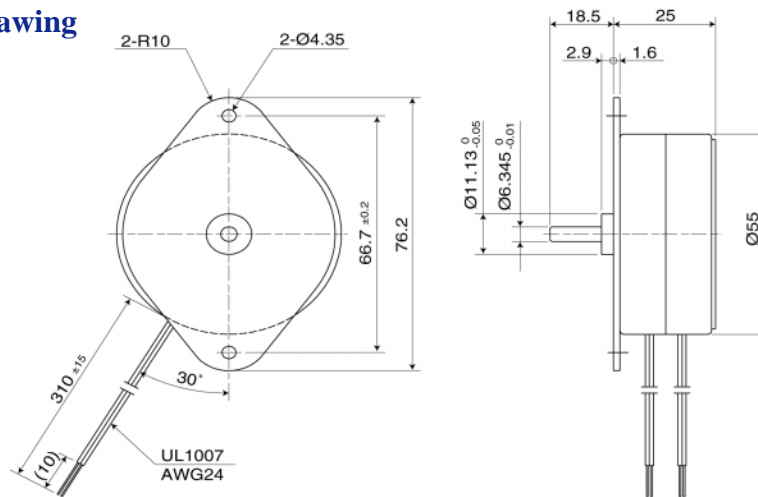

Dimensions in MM. Inches = MM*0.04

PF55-48C1 Unipolar Rated / Double Voltage Drive

PF55-48D1 Unipolar Chopper Drive at 24V

PF55-48P1 Bipolar Rated / Double Voltage Drive

PF55-48Q1 Bipolar Chopper Drive at 24V

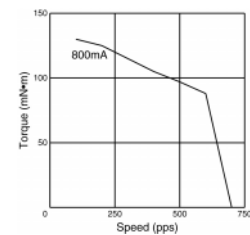
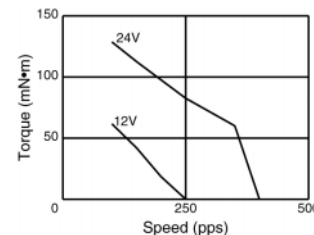
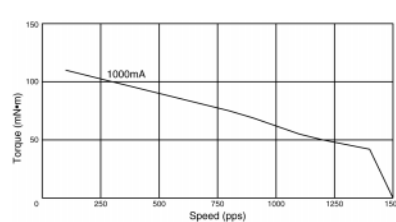
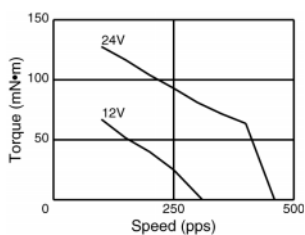

Torque Curve Note: 1 mN•m = 0.14 oz-in