

# Hybrid Stepping Motor

Type: 2.0Nm 2.0A

CNC PROFI KJ

Tel.: +49 30 4942661

E-mail: info@cncprofi.eu

specifications:

MODEL	PHASE	STEP ANGLE ± 5% DEG/STEP	RATED VOLTAGE V	CURRENT /PHASE A	RESISTANCE /PHASE ± 10% ohms	INDUCTANCE /PHASE ± 20% mH	HOLDING TORQUE N.m	DETENT TORQUE N.cm	ROTOR INERTIA g.cm <sup>2</sup>	WEIGHT kg
	2	1.8	7.2	2.0	3.5	10	2.0	6.0	480	1.0

Temperature Rise-----80°C Max.

Ambient Temperature Range-----20°C~+50°C

Insulation Resistance-----100Mohms Min.50V DC

Dielectric Strength-----500V DC 1minute

Insulating class-----B

## COLORS OF LEAD WIRES BIPOLAR

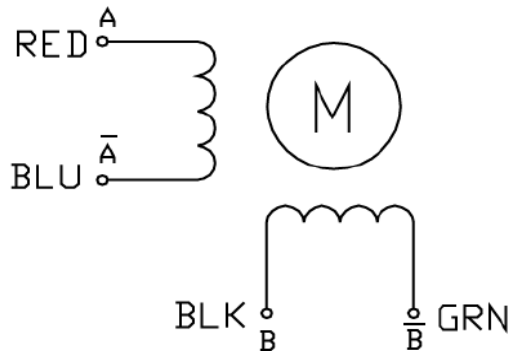

## WIRING DIAGRAM

CW DIRECTION	STEP	A	Ā	B	B̄
↓	1	+		+	
	2		+	+	
	3		+		+
	4	+			+
	1	+		+	

CW see from the flange side

Dimension:

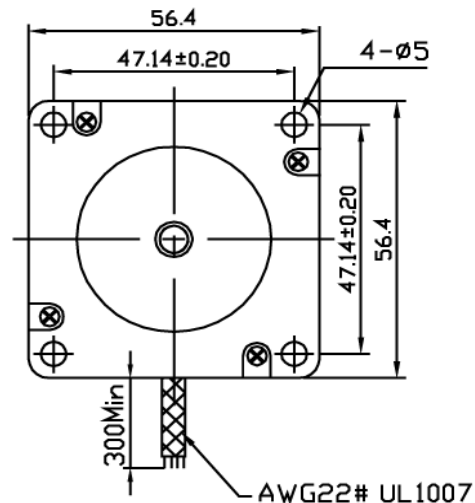
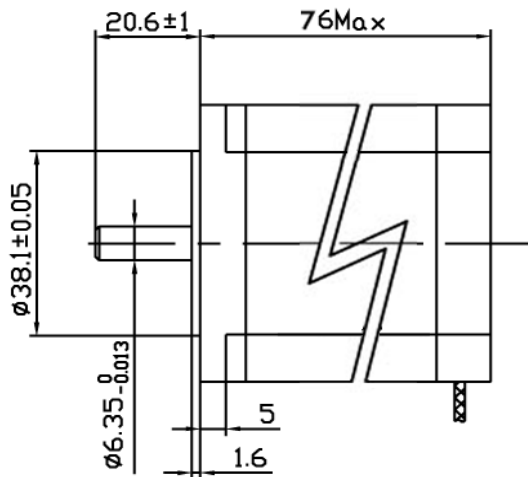

**CNC Profi Ltd.**

Biesdorfer Weg 21  
D-12683 Berlin Germany

Geschäftsführer: Jacek Maciejewski  
HRB 114651 Amtsger. Berlin

Tel.: +49.30.4942661  
Fax: +49.30.51656089

E-mail: info@profikj.de  
www.cncprofi.eu